

用于消防，道路养护车辆
垂直中载荷断轴取力器 "边行车边泵水功能"

一般定义



垂直中载荷断轴取力器 "4轴"

PTO输出可以在运动中运行，PTO输出可以指定为主变速箱侧或差速侧

在PTO输出的情况下，PTO输出可以相互独立工作。PTO输出可以是DIN和ISO标准法兰，ISO和UNI标准也可以设计用于泵的直接连接。

自润滑

控制类型：气动和机械

安装类型：分体式轴

可选组件

速度传感器
结合/脱开传感器
鼓式制动器
冷却系统
第二个PTO输出

用于消防，道路养护车辆

技术说明

| 技术参数 | | | |
|-------|---------|------------------------|---------------|
| | 最大值 | 速比 | 工作范围 (最大值) |
| ① & ② | 7850 Nm | 1/1 | - |
| ③ | 135 kW | 1/1.1 - 1/1.7 - 1/1.96 | 2500-3300 RPM |
| ④ | | | |

| | |
|------|----------------------|
| 重量 | 175 kg |
| 主体材质 | GGG-50 |
| 油量 | 80W 90 & 4,2 lt (垂直) |

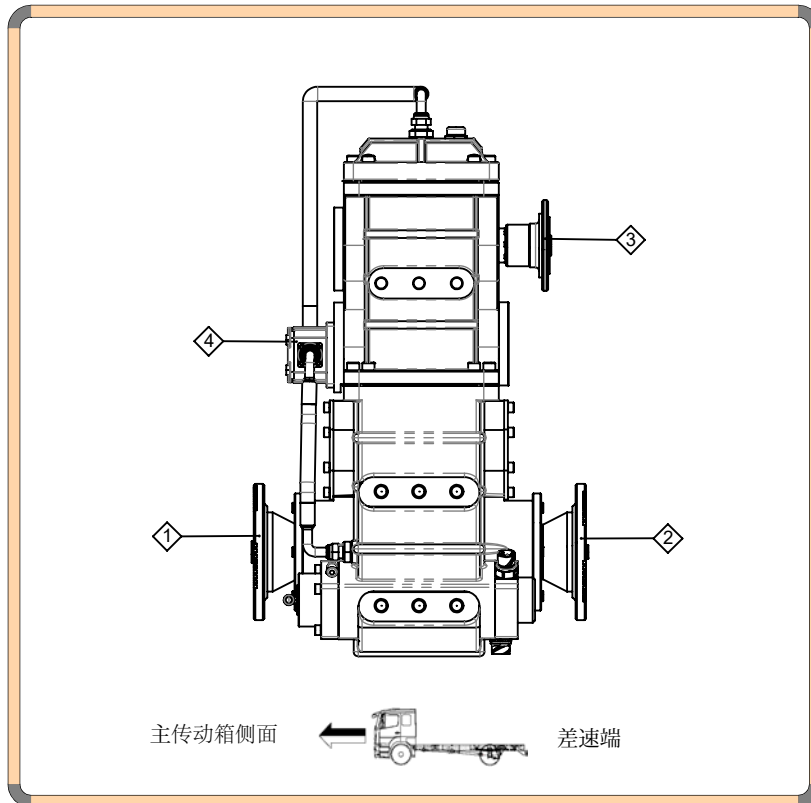

- Kozmaksan Şirketi katalogda verilen bilgileri önceden bildirmeden değiştirme hakkını saklı tutar. Bu belge genel bilgiler içerir ve taahhüt ve sözleşme niteliğinde değildir.
- Verilen güç ve tork bilgileri sadece PTO/ara şanzımana aittir. Uygulama yapılacak şanzıman, motor ve aracın PTO/ara şanzıman için uygun gördüğü değerleri aşmayınız.
- Şanzımana civata ile bağlanan PTO'lara takılacak pompa, şaft vb. parçaların ağırlık ve askıda kalan uzunlukları şanzıman ve araç üreticisinin onayladığı limitleri geçmemelidir.

用于消防，道路养护车辆

输出口描述

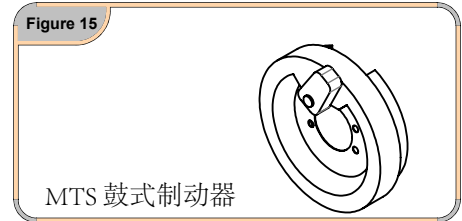
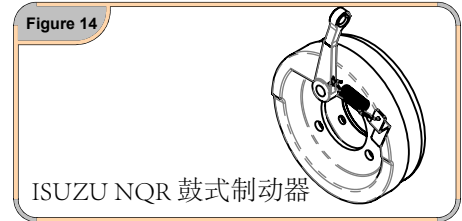
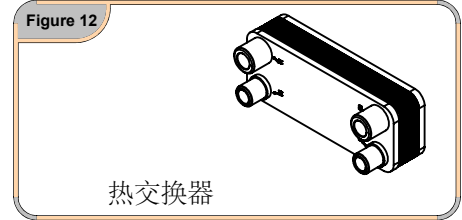
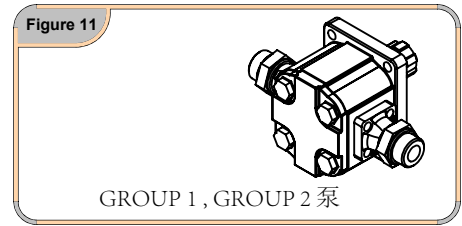
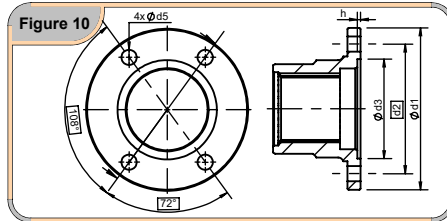
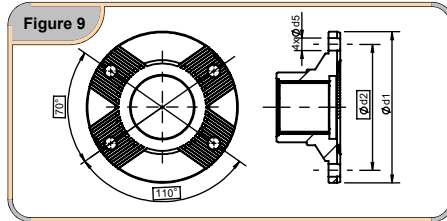
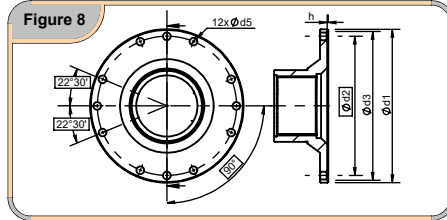
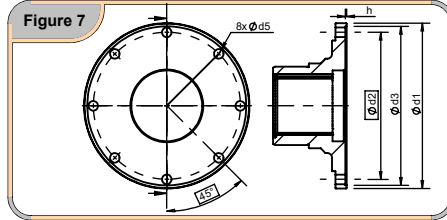
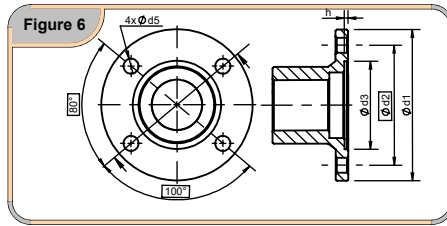
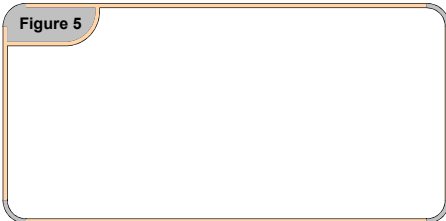
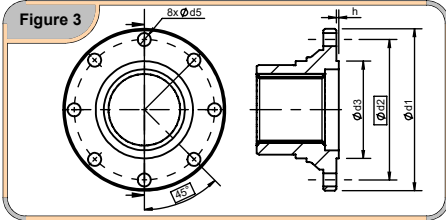
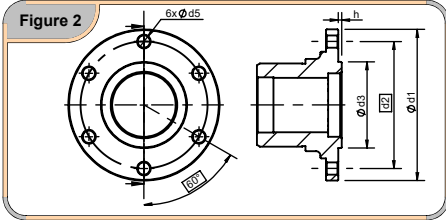
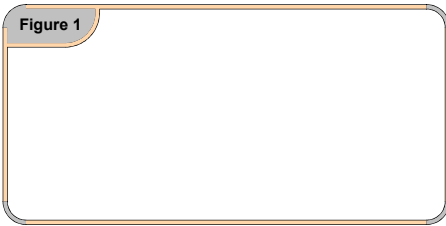

| 图号 | 螺栓数量 | Ø d1 | Ø d2 | Ø d3 | Ø d5 | h | 标准 | 1 | 2 | 3 | 4 | 5 | 6 |
|----|------|------|--------|--------|------|-----|--------------------|---------|---------|---------|---------|---|---|
| 1 | - | - | - | - | - | - | | | | | | | |
| 2 | 6 | 100 | 84 | 57 | 8,1 | 2,3 | ISO 7646 - DIN 100 | | | | C06-011 | | |
| 3 | 8 | 120 | 101,5 | 75 | 10,1 | 2,3 | ISO 7646 - DIN 120 | | | | C06-061 | | |
| 3 | 8 | 150 | 130 | 75 | 12,1 | 2,3 | ISO 7646 - DIN 150 | C06-044 | C06-044 | | | | |
| 6 | 4 | 87 | 69,85 | 57,10 | 8,1 | 2 | ISO 7647-SAE1100 | | | | C06-203 | | |
| 6 | 4 | 146 | 120,65 | 95,25 | 12,1 | 2,3 | ISO 7647-SAE 1510 | C06-028 | C06-028 | | | | |
| 6 | 4 | 116 | 95,25 | 69,85 | 12,1 | 2,3 | ISO 7647-SAE1400 | C06-154 | C06-154 | C06-007 | | | |
| 6 | 4 | 97 | 79,37 | 69,85 | 10,1 | 2,3 | ISO 7647-SAE1300 | | | C06-144 | | | |
| 6 | - | - | - | - | - | - | | | | | | | |
| 7 | 8 | 175 | 155,57 | 168,22 | 10,1 | 1,5 | ISO 7647-SAE1600 | C06-009 | C06-009 | | | | |
| 8 | 12 | 203 | 184,15 | 196,86 | 10,1 | - | ISO 7647-SAE1800 | | | | | | |
| 9 | 4 | 180 | - | 15 | - | - | ISO 8667 - T 180 | C06-005 | C06-005 | | | | |
| 9 | 4 | 150 | - | 13 | - | - | ISO 8667 - T 150 | | | | | | |
| 10 | - | - | - | - | - | - | | | | | | | |

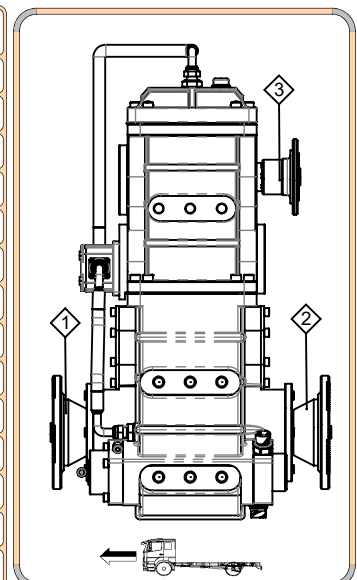

如果您有任何问题或要求，请联系KOZMAKSAN.